

Specification

July 2024

Product:	TFT LCD Display
----------	-----------------

APT Model:	750CM
------------	-------

Client Model:	
---------------	--

Client:	
---------	--

Client Check:

Supplier:	APT(Tianjin) Development Co., Ltd. 1001, Building 5 HuaDing, No.1 HuaKe 3 Road, Binhai hi-tech Industrial Development Zone, Tianjin, China TEL: 86 22 26345859 FAX: 86 22 83719955
-----------	---

Email	yzhao@aptdevelop.com
-------	--

Approval:

Content

1	Product model	3
2	Suppliers	3
3	Specifications	3
4	Dimensions and Material	3
5	Features	4
6	Main page	4
7	Functional Description	5
7.1	Power on/off	5
7.2	Assist level	5
7.3	Speed & Mileage mode	6
7.4	Headlight / Display Mode	6
7.5	Walking mode (6km)	7
7.6	Data cleanup	7
8	Menu Page	7
8.1	Display settings	7
8.1.1	Language	8
8.1.2	System	8
8.1.3	Brightness	8
8.1.4	Auto off	9
8.1.5	Scenes	9
8.1.6	Clock	10
8.2	E-bike settings	10
8.2.1	Start password	10
8.2.2	Assist levels	11
8.2.3	Wheel	12
8.2.4	Battery	12
8.2.5	Battery Ind	12
8.2.6	Pow Ind	13
8.3	Advanced setting	13
8.3.1	Speed Limit	14
8.3.2	Current Limit	14
8.3.3	Poles In motor	14
8.3.4	Start after poles	15
8.3.5	Clockwise Start	15
8.3.6	Throttle 6km	15
8.3.7	Throttle Level	15
8.4	Factory Setting	16
8.5	Information	16
8.5.1	Product Information	16
8.5.2	Battery Information	17
9	Errors code	17
10	Assembly instructions	18
11	Install and use precautions	19



12	Copyright Notice	19
----	------------------------	----

1 Product model

Model: 750CM

2 Suppliers

APT (Tianjin) Development Co., Ltd.

3 Specifications

- 3.2inch TFT screen(480*RGB*320)
- Wide-voltage range:
Low voltage: 20~70V
High voltage: 20~90V
- Multi-language support (6 languages)
- Rated operating current : 40mA, Maximum output current to controller: 100mA、off-leakage current <1μA
- Operating temperature : -20~70℃、Storage temperature -30~80℃
- IP65
- EN15194/2017
- RoHS

4 Dimensions and Material

Shell and bracket is made with ABS, panel is tempered glass.

Dimensions: host/L110mm*W68.2mm*H68mm

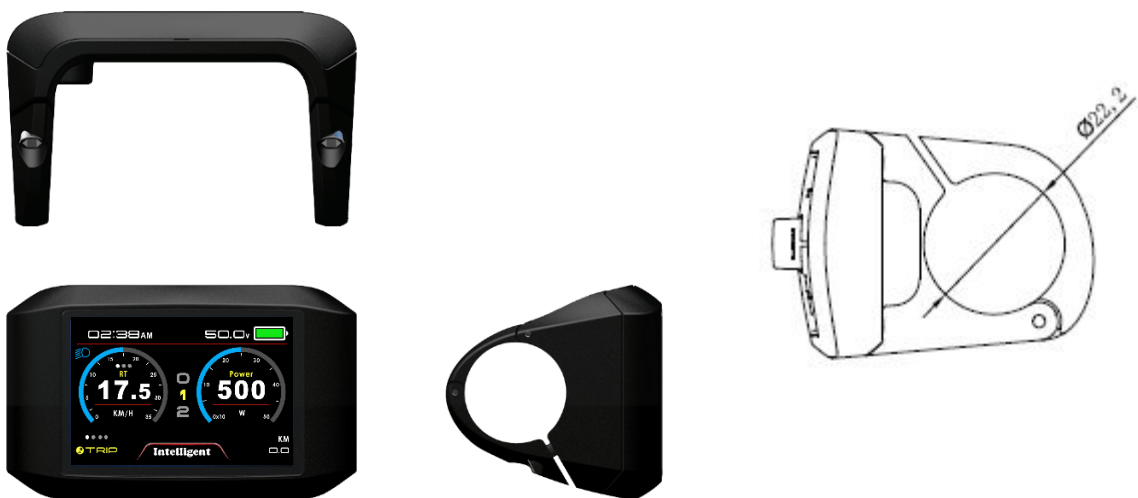

5 Features

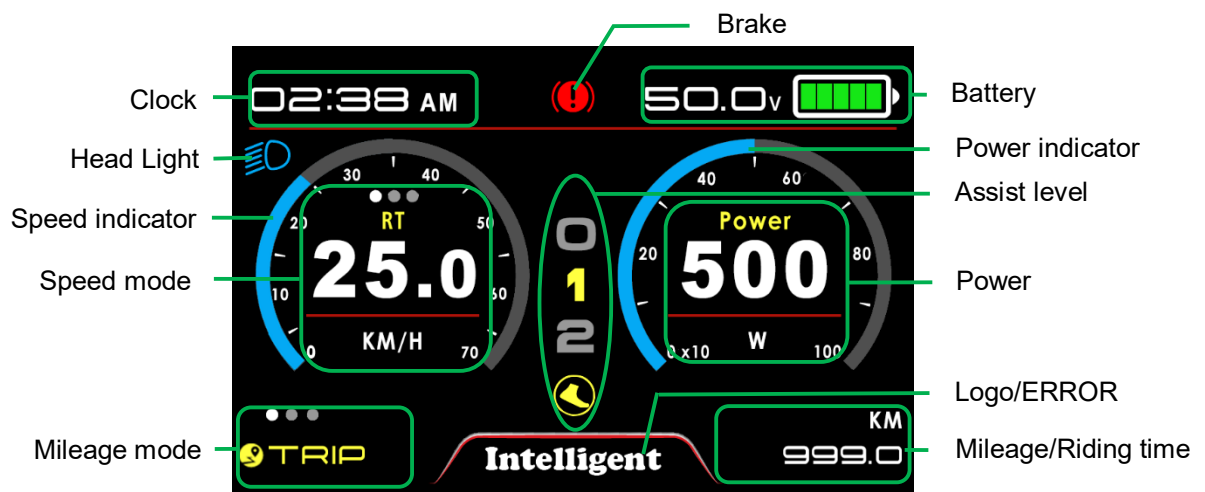

- **3.2inch TFT screen**
- **6 languages:**
Czech, German, French, English, Italian, Spanish are supported.
- **Independent button, easy to operate**
- **Speed indicator:** Speed (Real-time), AVG Speed, MAX Speed
- **Metric / Imperial**
- **Smart battery indicator:** Capacity (percentage) or Voltage
- **Mileage indicator:** Odometer, Trip distance
- **Clock indicator:** Built in battery, clock keeps running when power off
- **Brightness setting:** Day and Night Brightness can be set independent
- **9-level Assist:** 3-level/5-level/9-level/U optional
- **Power/ Current indicator:** Real-time Power(W) or Current(A)
- **Errors Code tips**
- **6km walking**
- **Firmware upgrade:** Upgrade the Logo individually

6 Main page



- **Clock:** 24hour or 12hour clock
- **Head Light:** Head Light on/ off.
- **Speed Mode:** Real-time Speed, AVG Speed, MAX Speed, Km/h or MPH
- **Speed indicator:** The maximum indication can be set to 35km/h or 70km/h

according to the speed limit, and the display of real-time speed value is not affected when the driving speed exceeds the maximum indication.

- **Mileage Mode:** Odometer, Trip distance, Riding time
- **Brake:** Indication  when braking
- **Smart battery Power indicator:** Provide a reliable battery Power indicator.
- **Assist Level:** 4 modes optional (3/5/9/U)
- **Power:** Real-time Power or Current.
- **Power indicator:** The maximum indication can be set to 1000W or 2000W according to the output of the battery, and the display of the actual power value is not affected when the power value exceeds the maximum indication.
- **Errors Code:** Show  when checking errors.
- **LOGO**

7 Functional Description

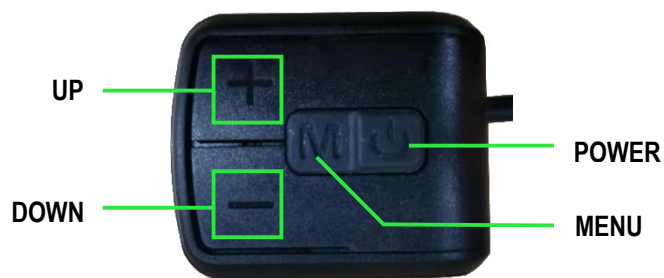

7.1 Power on/off

Press **POWER** button for 2 seconds, you can turn on/off the display. The Display can automatically turn off when there is no operating and riding for 5 minutes. (Length of time can be set, refer to 8.1.4 'Auto off')

*Input pattern in first if pattern unlock was activated.

*Display will be locked for 30 seconds after 3 times failed attempt.

7.2 Assist level

Press **UP/DOWN** button to change assist level, Top assist level is 9, 0 for neutral. Level quantities can be adjusted according to the customer requirements.

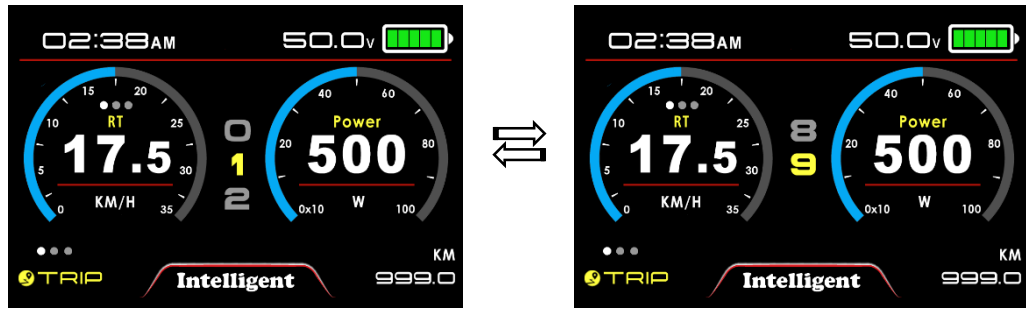

7.3 Speed & Mileage mode

Click **MENU** button can change the speed mode, **RT Speed**->**AVG Speed**->**MAX Speed**-> **RT Speed**.

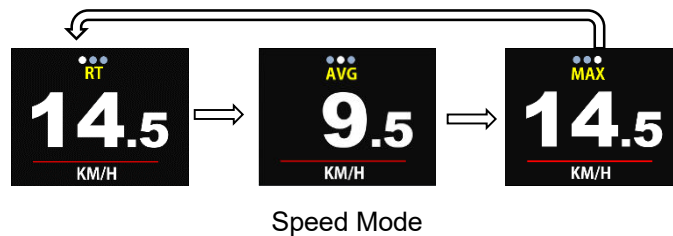

* At **MAX SPD** or **AVG SPD**, If there is no operation for 5 seconds, right item will restore to **RT Speed** automatically.

Click **POWER** button can change the mileage mode, **Trip**-> **Time** -> **ODO** ->**Trip**.



7.4 Headlight / Display Mode

Press and hold **UP** button for 2 seconds can turn on/off headlight, display will switch to the corresponding mode (Day or Night).

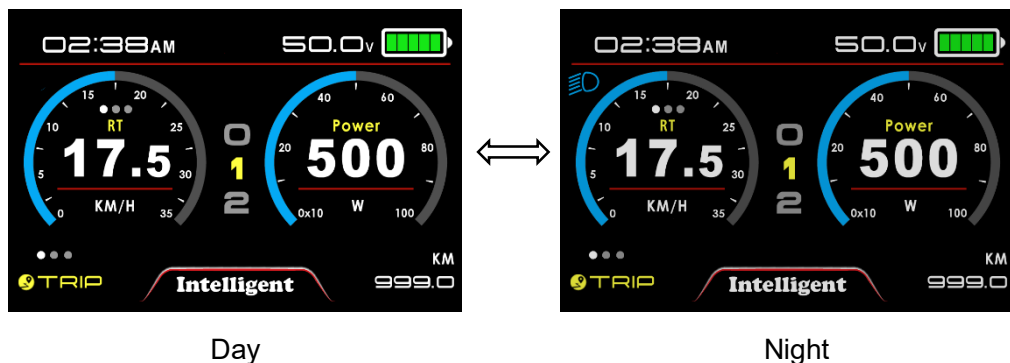

- * The brightness of the Display can be set according to the user's needs, Refer 8.1.3 Brightness.
- * The motor does not work when the battery voltage is low, Display still can keep the headlight

on for a while when E-bike is in riding.

7.5 Walking mode (6km)

Press and hold **DOWN** button for 2 seconds can get into walking mode, show 'P' on screen, out of walking mode when releasing button.

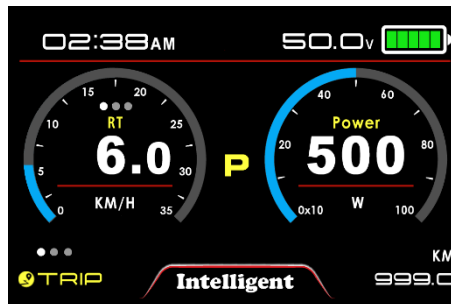

Walking Mode

7.6 Data cleanup

Press and hold **UP** & **DOWN** button together for 1 second can clean temporary data (TRIP, Riding-Time, AVG SPD, MAX SPD data).

* Temporary data is automatically saved when power off. Abnormal power outage will cause data lost.

* Restore Factory Mode (advanced settings in Menu Page) can clear temporary data (TRIP, Riding-Time, AVG SPD, MAX SPD, MENU settings) except ODO.

* ODO will reset to zero over 99999. TRIP will reset to zero over 9999.9.

8 Menu Page

Double press **MENU** button (press interval less than 0.3 second) can get into setting menus, press **UP/DOWN** button to change the parameter setting, press **MENU** button can switch to next item. Select EXIT or press **MENU** button twice to exit from menu.

* Display will automatically quit menu if there is no operation for 30 seconds.

* For safety reason, display will be locked on Main Page when riding (speed ≥ 2.0 km/h), function of MENU will be deactivated.

* Display didn't save setting until click MENU to confirm.

* Display doesn't quit parameter adjustment interface through pressing **MENU** button.

8.1 Display settings

Display settings include several items: Language, System, Brightness, Auto off, Scenes, Clock.

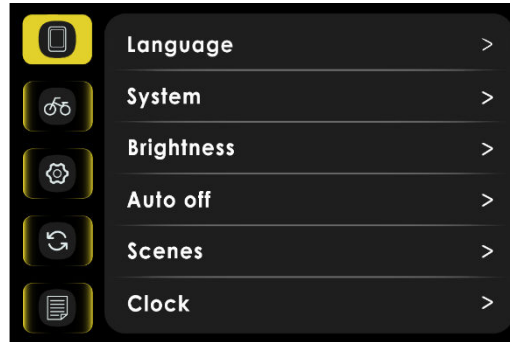

8.1.1 Language

6 languages are supported: Czech, German, French, English, Italian, Spanish. Default is English. Select language then click “Back” to confirm.

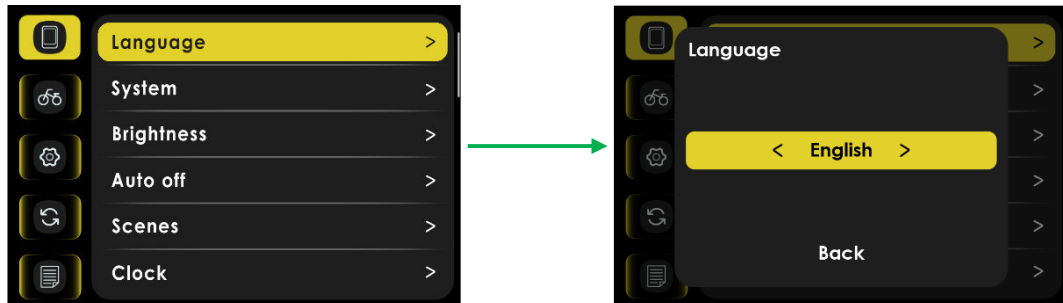

Language

8.1.2 System

Select Metric or Imperial.

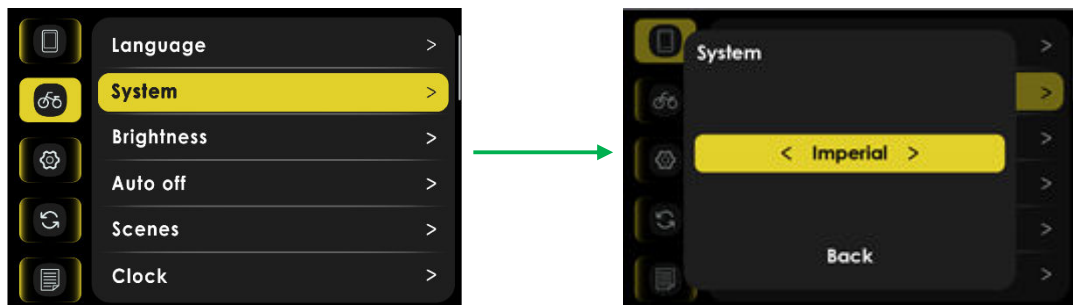

Metric and Imperial

8.1.3 Brightness

Press **UP/DOWN** button to change brightness of backlight, 1 is darkness, 5 is brightness.



8.1.4 Auto off

This item enables to set the automatic shutdown time of the display, from 1 to 10min. Default value is 5 minutes, represents display shut down when there was no operation and riding for 5 minutes. OFF indicates that the display disables automatic shutdown.

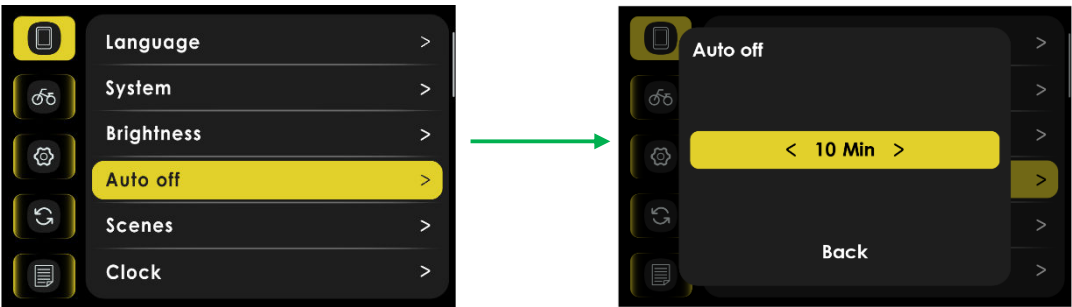

8.1.5 Scenes

Reserved, not yet in use.

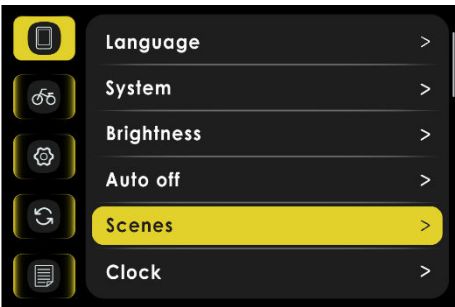

8.1.6 Clock

This item set date and time. You can choose Show-12 hour, Show-24 hour or hide Clock on Main Page through **UP/DOWN** button.

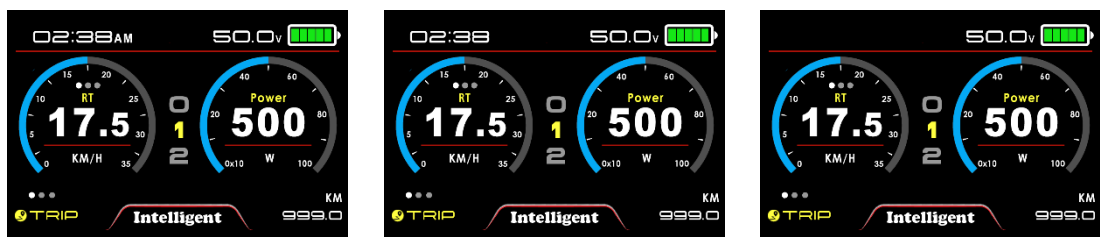
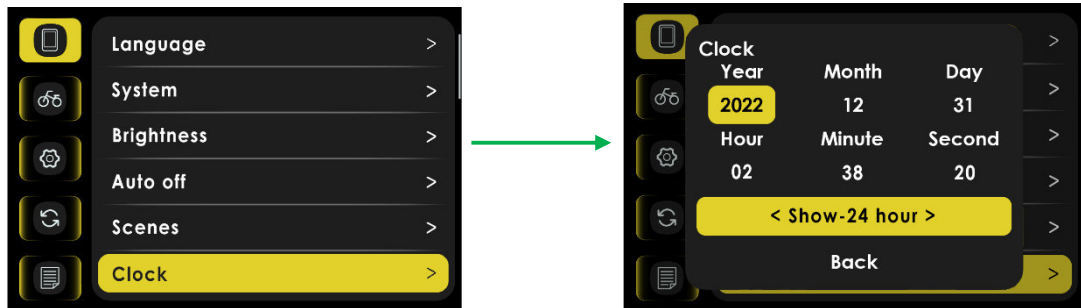

Show-12 hour

Show-24 hour

Hide

* Note: When display was powered off, internal Button Battery can keep clock running. When display is power on, Button Battery will be charged by external battery. Clock may slow or stop if Button Battery is low, please charge the battery as follows: Set “Automatic shutdown” to “OFF” (Disable power off automatically), keep the display power on for 72 hours. Full charged Button Battery can keep clock running at least 3 months without charged.

8.2 E-bike settings

E-bike settings include several items: Start password, Assist levels, Wheel, Battery, Battery Ind, Pow Ind.

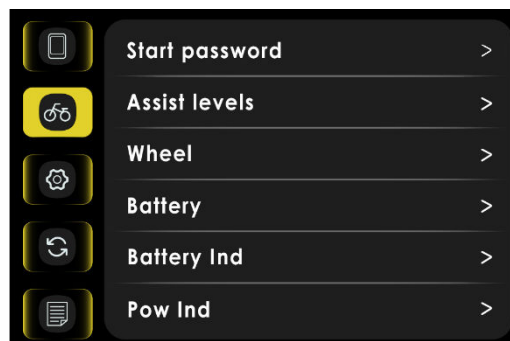

8.2.1 Start password

The start password includes two parameter settings, Start password, OFF/ON.

If you had set start password **ON**, you must input right password before power on.

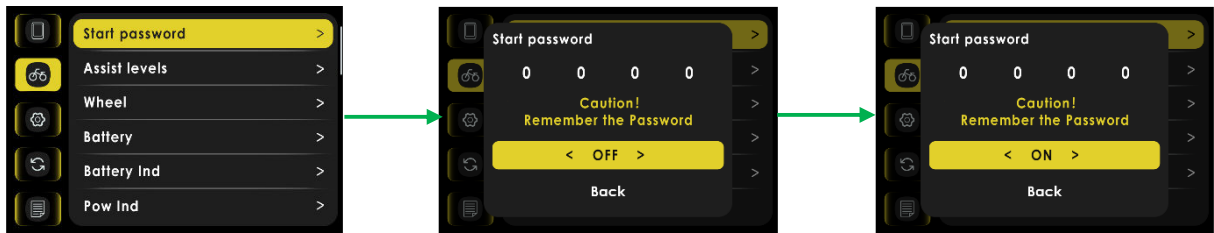

Turn on the start password function

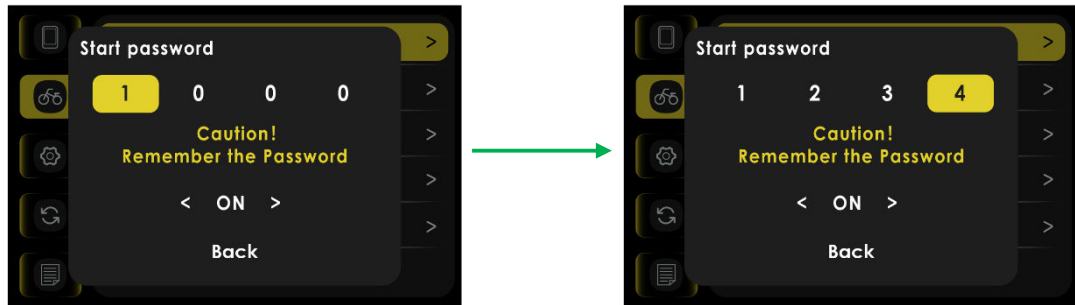

Start password setting page

You need to input the right password before start with 60 seconds.

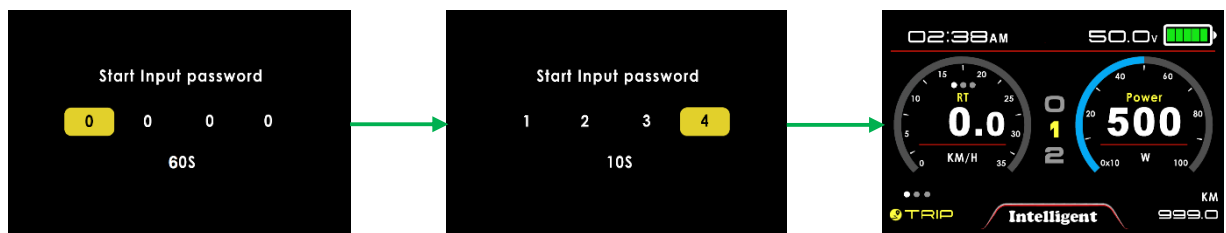

The boot page after setting the start password

* Display will automatically shut down if the correct password is not entered within 60S. Press and hold the **POWER** button to shut down while entering the password.

* Display will automatically shut down if the password was entered incorrectly 3 times.

8.2.2 Assist levels

This item can select assist levels, options are 3/5/9/U(6).

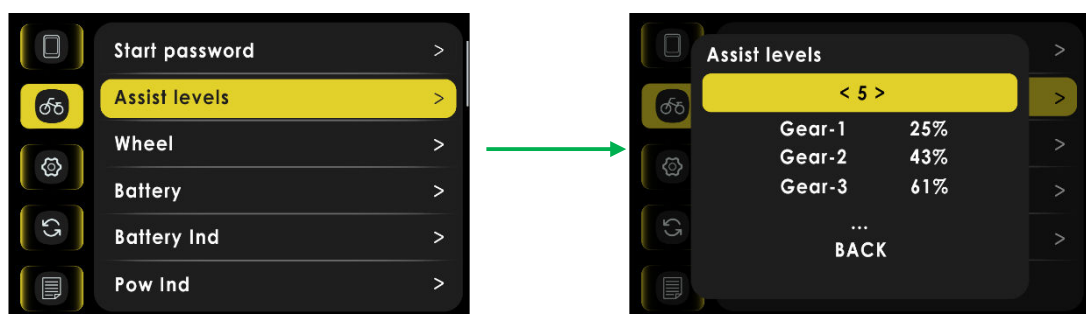

8.2.3 Wheel

This item can select wheel diameter, including 10~34 inch, 51cm~255cm. Incorrect wheel diameter selection can lead to abnormal speeds.

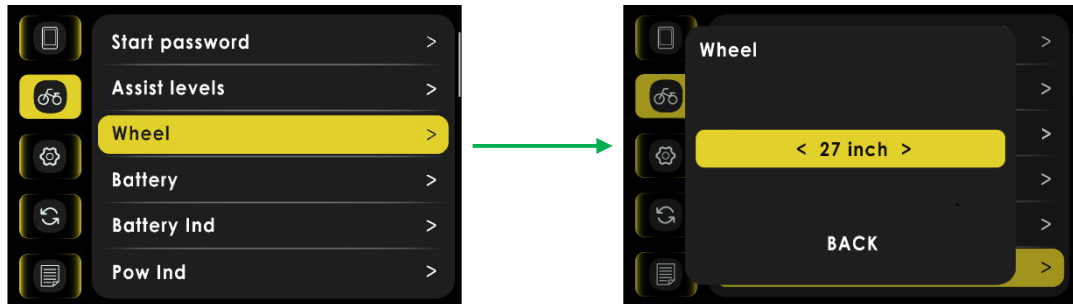

8.2.4 Battery

The following voltage settings are supported:

Low voltage: 24V/36V/48V/52V

High voltage: 48V/52V/60V/72V

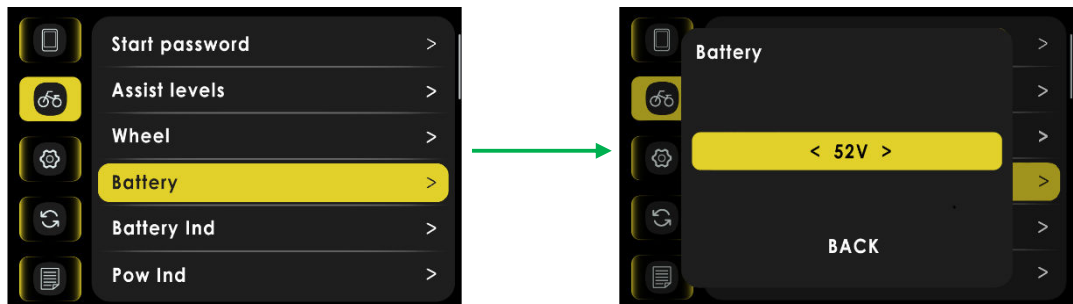

8.2.5 Battery Ind

This item can select battery Ind setting, including OFF/Percent/Voltage.

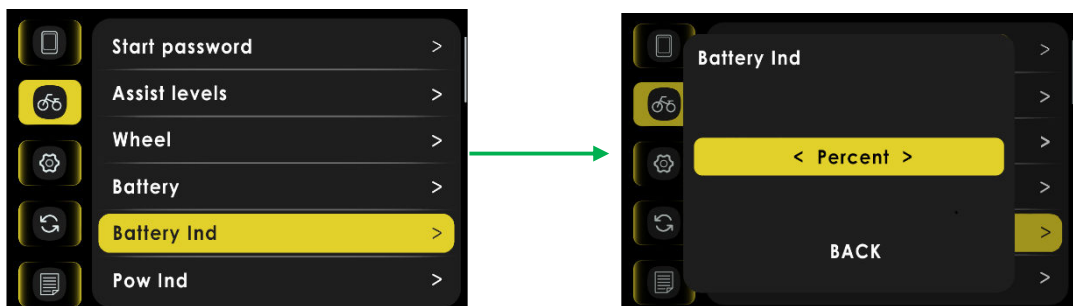

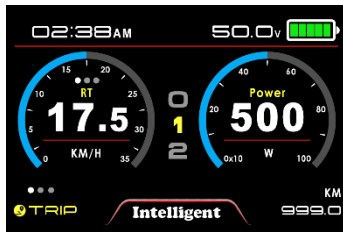

Voltage

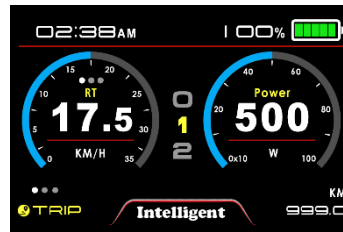

Percent

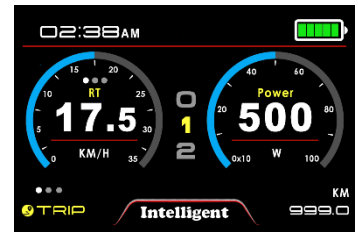

OFF

Note: The voltage is the remaining voltage or percentage of the battery.

8.2.6 Pow Ind

This item can select power indicator on Main Page, 'OFF', 'Power(W)' and 'Current(A)'.

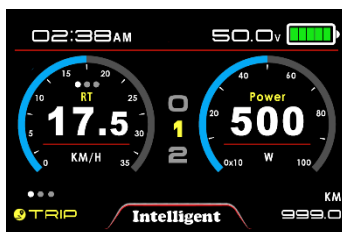
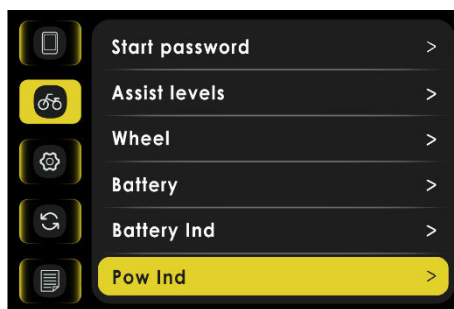

Output power (W)

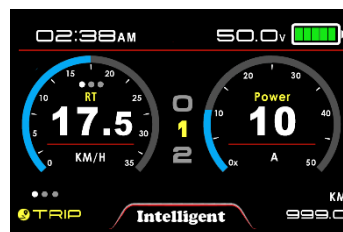

Output current (A)

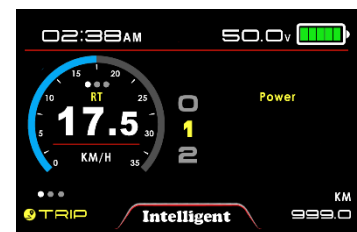

Power (OFF)

Note: Power indicator represent battery's output power (current), not motor.

8.3 Advanced setting

Advanced setting has password to prevent illegal modification, default password is '1919', password may be different according to request.

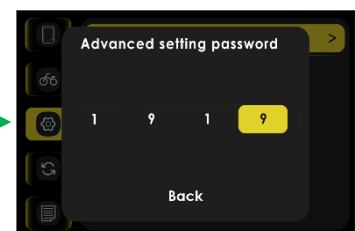
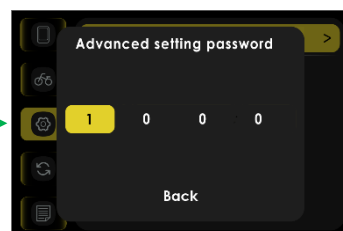
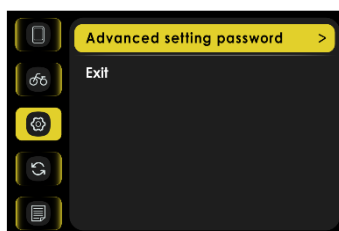

Advanced settings include Speed Limit, Current Limit, Poles In motor, Start after poles, Clockwise Start, Throttle 6km, Throttle Level, and the error code messages of the last 10 times.

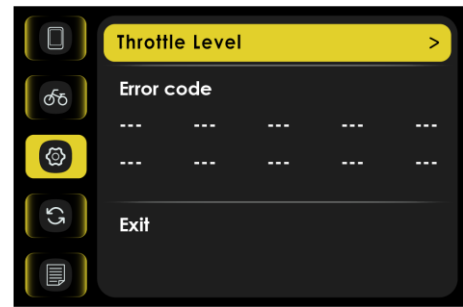
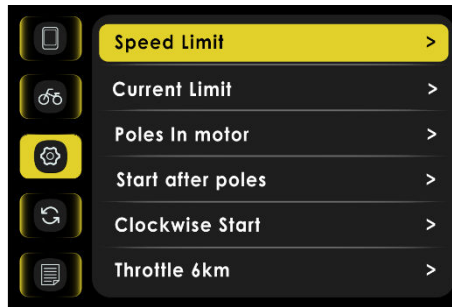

8.3.1 Speed Limit

Select range 10km/h ~ 60km/h, 99km/h (6.2Mile/h ~ 37.2Mile/h, 61.4 Mile/h) .

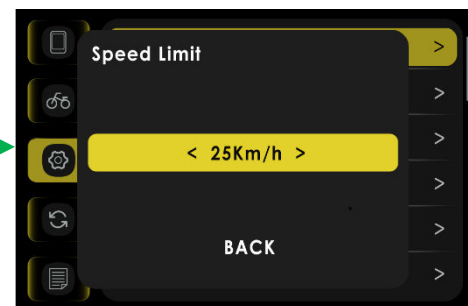
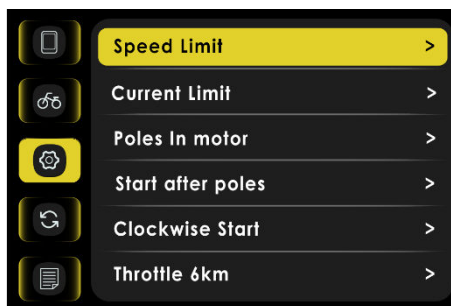

8.3.2 Current Limit

Select range 0~25A.

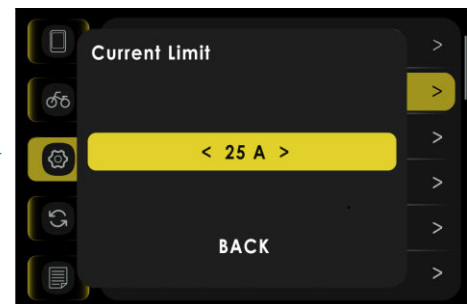
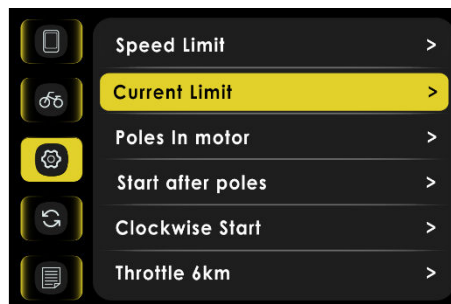

8.3.3 Poles In motor

Magnetic poles inside the motor, select range 1~15.

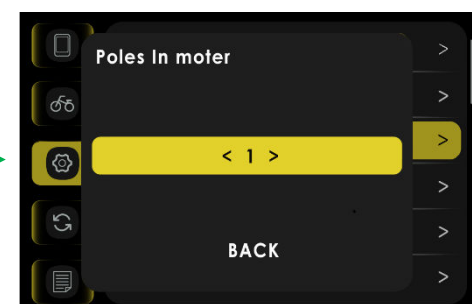
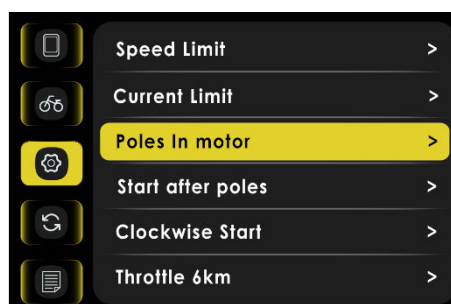

8.3.4 Start after poles

How many poles (speed sensor) need to be detected by controller before starting motor, select range 5/8/12.

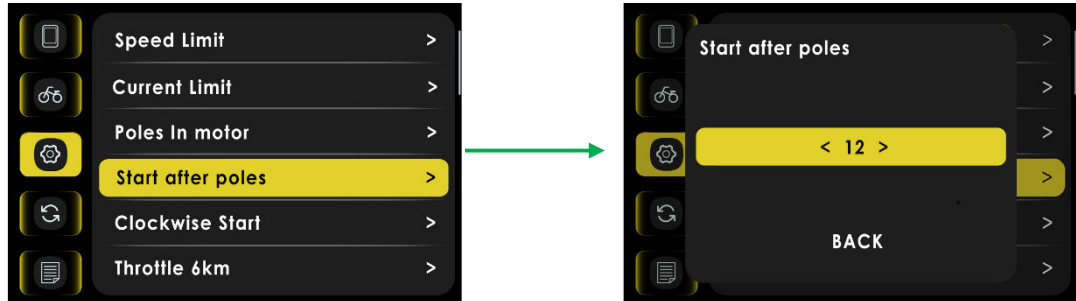

8.3.5 Clockwise Start

This parameter represent speed sensor turn direction, support front or reverse.

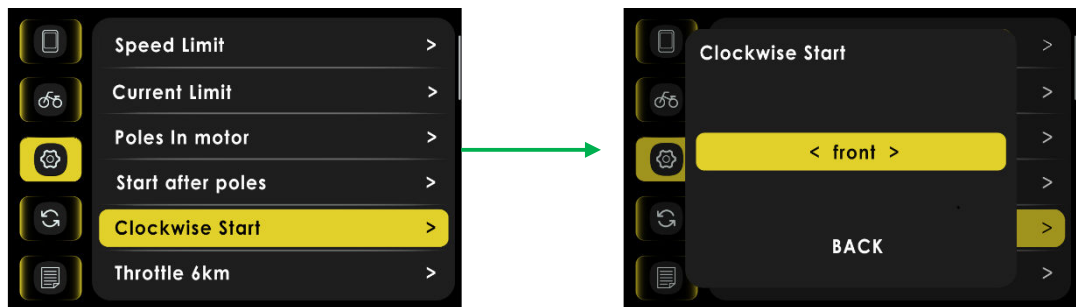

8.3.6 Throttle 6km

Support OFF or ON, OFF represents max speed, ON represents 6Km.

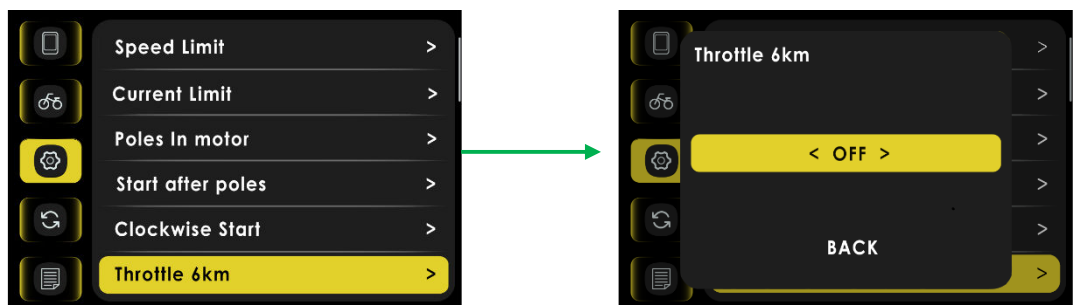

8.3.7 Throttle Level

This parameter is functional when Throttle 6KM set OFF. Support OFF or ON, OFF represent throttle start max speed, ON represent throttle's speed is accorded to the assist level.

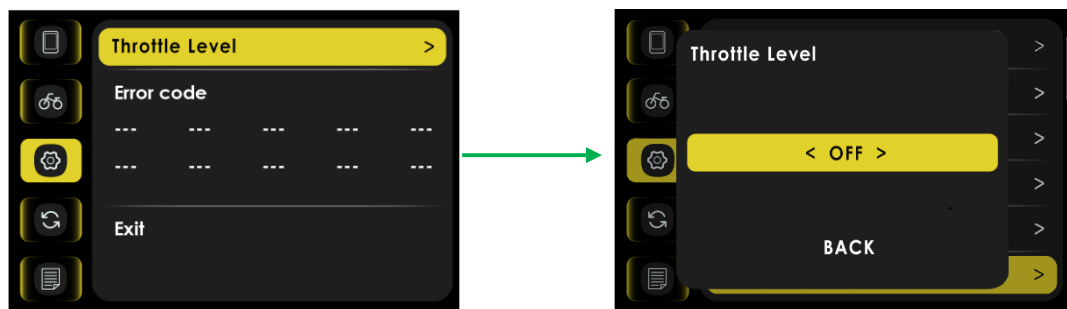

8.4 Factory Setting

Select 'YES' will restore all setting to factory defaults.

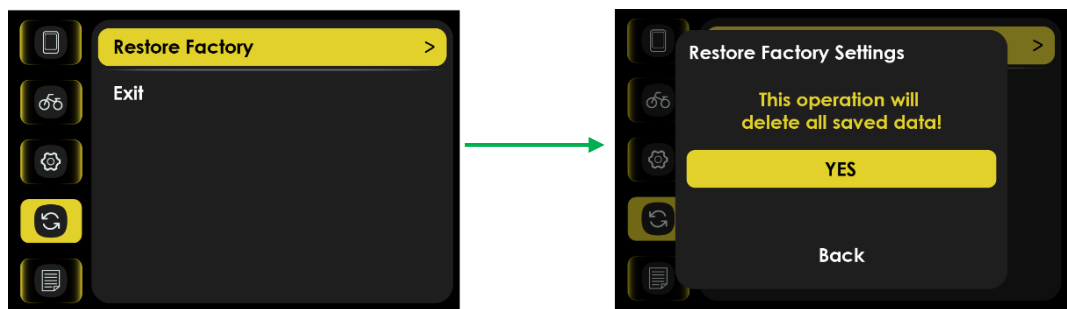

Note: ODO and CLOCK data are not cleared.

8.5 Information

The information display interface includes: Speed and Mileage Information, Product Information, Battery Information.

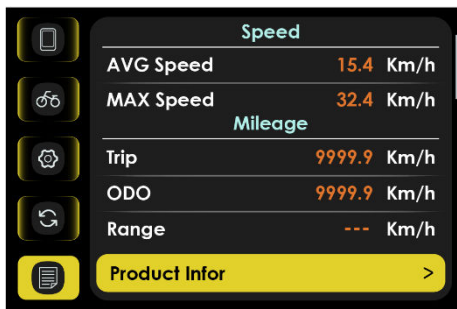

8.5.1 Product Information

Product Information show Hardware Version, Software Version, Date.

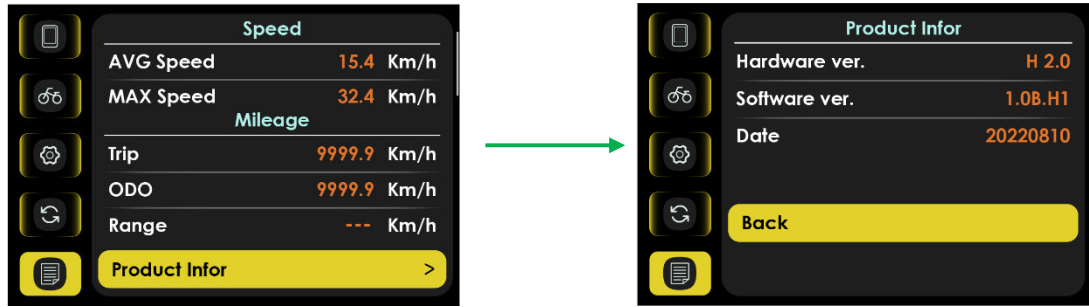

Product information

8.5.2 Battery Information

Battery Information can show Voltage, Capacity, Cycle times, Current, Last Uncharge Times, Temperature, Remaining Capacity, Full Charge Capacity, Max Uncharge Times.



Battery Information

Note: The battery information is displayed when the E-bike is equipped with battery with communication function.

9 Errors code

Display shows error code and  at the bottom of the screen when system checked abnormal.

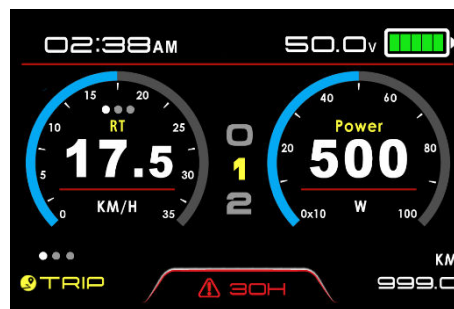

Error code prompt page

Error code	Error description	Handle
01	Communication Error(transmitted by the controller and displayed on the screen)	Check the cable connection
02	Controller protection	Check three-phase power cable

03	Three-phase power abnormality	Check three-phase power cable connection
04	Battery low	Charge the battery
05	Brake failure	Check the brake lever connection
06	Handlebar abnormality	Check the handlebar connection, If normal, replace the handlebar
07	Hall sensor error	Check the hall connection
08-0F	Reserved	Reserved
30	Communication failure(The Display does not receive communication from the controller)	Check the cable connection

10 Assembly instructions

Please pay attention to the torque value, exceeding the maximum torque can damage the part.

Electrical or pneumatic tools is not recommended.

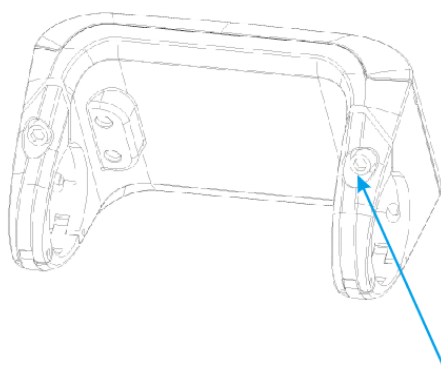

M4*10
STD=0.1N.M
MAX=0.2NM

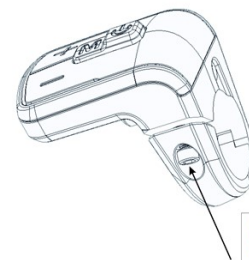

M3*10
STD=0.25N.M
MAX=0.4N.M

Clamps suit for 3 sizes of handlebar, 31.8mm, 25.4mm, 22.2mm, there are transfer rings for 25.4mm and 22.2mm (marked with L or R), transfer ring must be assembled with the special directions, pay attention to the green arrow below.

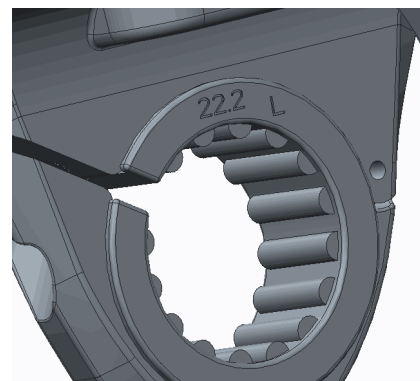
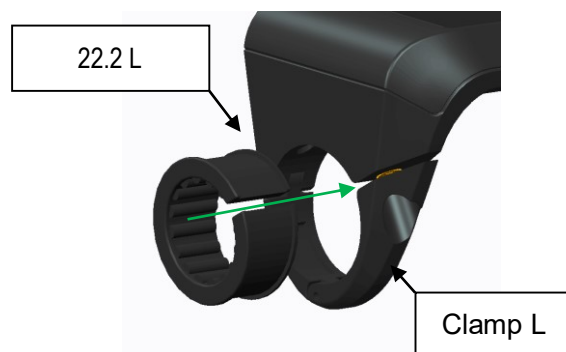

11 Install and use precautions

Do not adjust viewing angle before loose the screws.

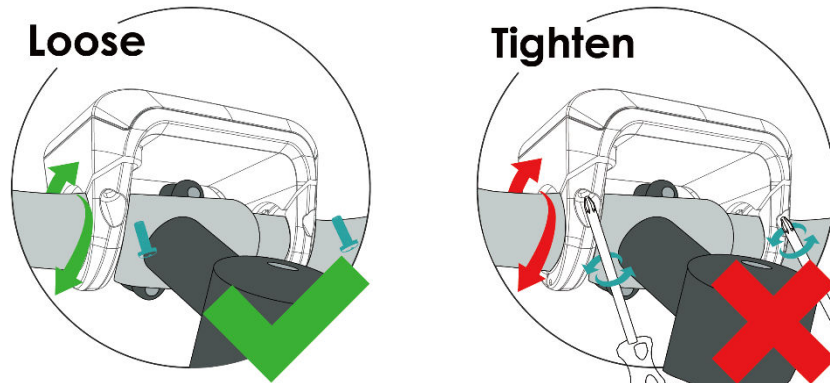

12 Copyright Notice

Questions about your e-bike, please contact with dealer firstly.

APT reserves the right to modify this specification file, without declaration in advance.

Content and Image owner: APT (Tianjin) Development Co., Ltd.

1001, Building 5 HuaDing, No.1 HuaKe 3 Road, Binhai hi-tech Industrial Development Zone, Tianjin, China

website : www.aptdvelop.com